

	Customer	Customer (P/N)	Description LF IND L345 μ H 5% 125KHz		
	Premo (P/N) KGEA-BFWX-B-0345J	Prototype Ref.	Date 25/09/2019	Edition 1	Page 1/5

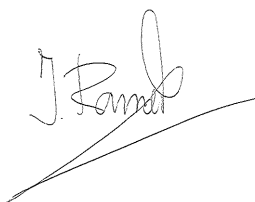

KGEA-BFWX L345 μ H 5%125KHz

Made by: José Ramón Fdez	Checked by: C. Cañete	Approved by: Jonatan Muñoz
Date: 25/09/2019	Date: 25/09/2019	Date:
Signature: 	Signature: 	Signature:

	Customer	Customer (P/N)	Description LF IND L345μH 5% 125KHz		
	Premo (P/N) KGEA-BFWX-B-0345J	Prototype Ref.	Date 25/09/2019	Edition 1	Page 2/5

1. Features

- High stability in temperature (-40°C up to +85°C)
- LF transponder Transmitter antenna.
- Ideally used in keyless smart entry system.
- Connector (unsealed & sealed) located outside assembly housing plastic base.
- Connector and length cable (to be determined by the supplier and customer).
- Low tolerances in the inductance L
- Long reading distances and current maximum until 2-4App
- Strong anchor points which provide an easy assembly

2. Applications

Ideally used access and start Hand Free subsystem for
Passive Entry keyless Go System Requirements for automotive application.

3. Electrical diagram



L: Ferrite core coil inductance.

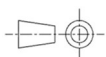

Dimensions: mm

(*) Critical characteristics

	Customer	Customer (P/N)	Description LF IND L345μH 5% 125KHz		
	Premo (P/N) KGEA-BFWX-B-0345J	Prototype Ref.	Date 25/09/2019	Edition 1	Page 3/5

4. Mechanical dimensions

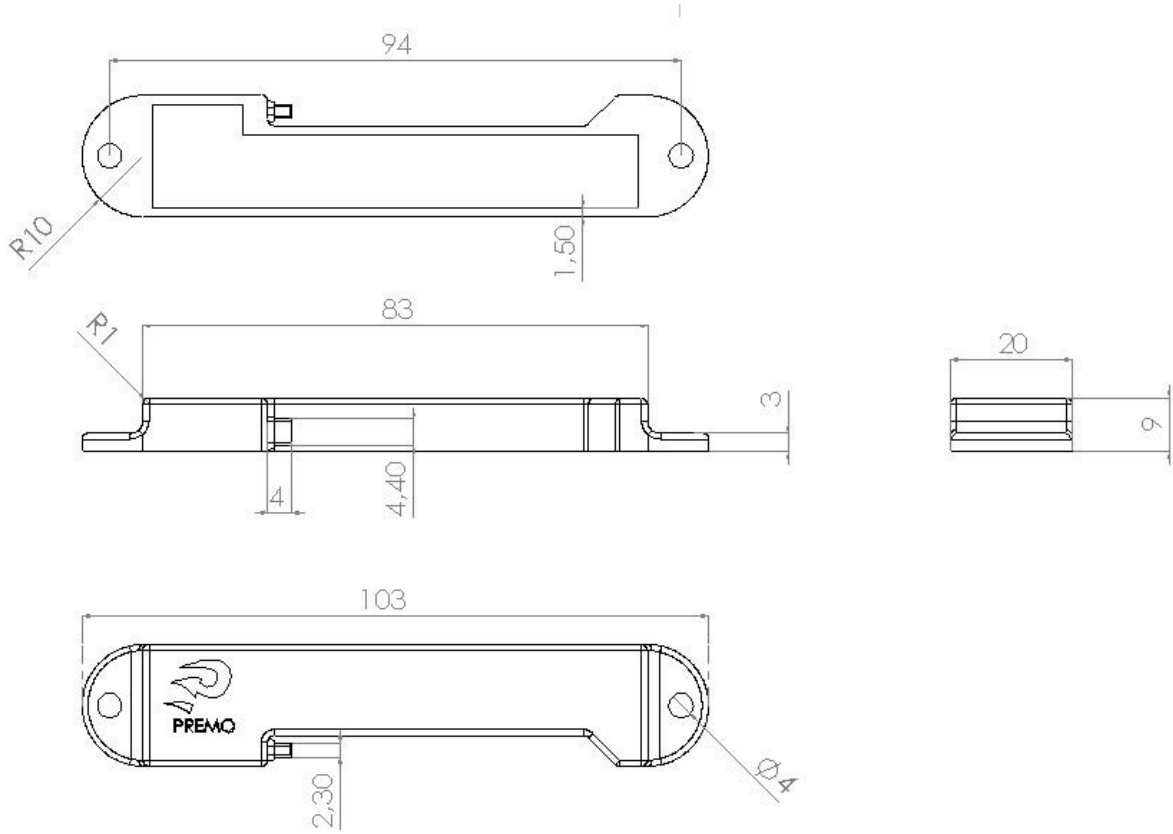

Outside cable:

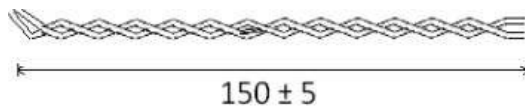

Twisting cycle: 20 ± 2.5 mm
Tripping cable length: 4 ± 1 mm

Notes:

General tolerances according ISO 2768 — 1 m if not define

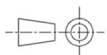

Dimensions: mm

(*) Critical characteristics

	Customer	Customer (P/N)	Description LF IND L345μH 5% 125KHz		
	Premo (P/N) KGEA-BFWX-B-0345J	Prototype Ref.	Date 25/09/2019	Edition 1	Page 4/5

5. Electrical parameters

SYMBOL	PARAMETER	CONDITIONS	MIN	TYP	MAX	UNITS	REMARKS
L	Inductance	25°C , 125KHz	327,75	345	362,25	μH	*
Fo	Resonant frequency	25°C		125		KHz	
Q	Quality factor (L+C)	25°C	100				*
Ipp	Current Peak to Peak	25°C			2-4	Amp	The maximum current value depends wire diameter used in the assembly

Notes:

Measures at 25 ° C +/- 2 °C

6. Raw materials

CORE	Ferrite Core MnZn 68x7x3mm
WIRE	Enameled Cu wire 0.16/UEW/P155/UL
WALL BUSING	PA
EXTERNAL HOUSING	PA66 Black
RESIN	Bi-Component PU Resin

7. Marking

Laser Marking on housing top side:

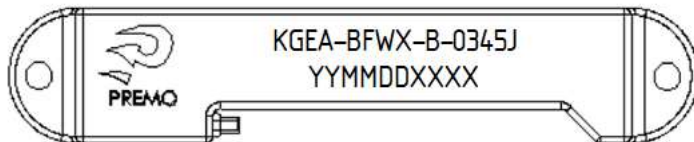

Where:

YY: Year

MM: Month

DD: Day

XXXX: Serial number to identify the part

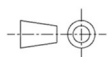

Dimensions: mm

(*) Critical characteristics

	Customer	Customer (P/N)	Description LF IND L345μH 5% 125KHz		
	Premo (P/N) KGEA-BFWX-B-0345J	Prototype Ref.	Date 25/09/2019	Edition 1	Page 5/5

8. Packaging

Packaging: 24pcs/layer * 7 layer = 168pcs/box

9. Edition Control

ED	CHANGE BY	DATE	CHANGE DESCRIPTION
1	J.R.Fdez	25/09/19	Based in the part KGEA-BFCWX-B-0345J but without Capacitor, Only L-inductance. Critical electrical parameters: L and Q. Length ASSY Cables is 150±5mm. Marked by laser marking

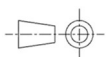

Dimensions: mm

(*) Critical characteristics